

# PEWAUKEE LAKE DEVELOPMENT SITE

## 1.3 ACRES ON LAKE & 1.23 ACRES ON PROSPECT AVE.

### Property Highlights

- 302 FT of Pewaukee Lake Frontage
- 281 FT of Prospect Avenue Frontage
- Zoned Commercial
- Property has a marina license
- Secondary access off of Edgewood

### Sale Price:

**\$3,200,000**

**\$10,596 / front foot**



### CONTACT:

**Pete Slezak**  
414-272-6721  
pslezak@barrycr.com

**Kurt Van Dyke, CCIM, SIOR**  
414-272-6726  
kurt@barrycr.com



Commercial Real Estate Services  
Since 1921

1232 NORTH EDISON STREET | MILWAUKEE, WI 53202 | 414-271-1870 MAIN | 414-271-1478 FAX | WWW.BARRYCRE.COM

The information contained herein was lawfully obtained from sources we consider reliable but may contain errors, omissions, approximations or outdated information. The Barry Company, its employees and independent contractors make no representations or warranties whatsoever regarding: (1) the accuracy of the information contained herein and (2) the physical or environmental condition of this property or any part of this property. Prospective purchasers are strongly encouraged to conduct an independent investigation of the condition of this property.

# PEWAUKEE LAKE DEVELOPMENT SITE

## 1.3 ACRES ON LAKE & 1.23 ACRES ON PROSPECT AVE.



### CONTACT:

**Pete Slezak**  
414-272-6721  
pslezak@barrycr.com

**Kurt Van Dyke, CCIM, SIOR**  
414-272-6726  
kurt@barrycr.com



Commercial Real Estate Services  
Since 1921

1232 NORTH EDISON STREET | MILWAUKEE, WI 53202 | 414-271-1870 MAIN | 414-271-1478 FAX | WWW.BARRYCRE.COM

The information contained herein was lawfully obtained from sources we consider reliable but may contain errors, omissions, approximations or outdated information. The Barry Company, its employees and independent contractors make no representations or warranties whatsoever regarding: (1) the accuracy of the information contained herein and (2) the physical or environmental condition of this property or any part of this property. Prospective purchasers are strongly encouraged to conduct an independent investigation of the condition of this property.



### Legend

#### Retired Plats

- Assessor Plat
- Condo Plat
- CSM
- Subdivision Plat

#### Simultaneous Conveyance

- Assessor Plat
- CSM
- Condo Plat
- Subdivision Plat

### CONTACT:

**Pete Slezak**  
 414-272-6721  
 pslezak@barrycre.com

**Kurt Van Dyke, CCIM, SIOR**  
 414-272-6726  
 kurt@barrycre.com



0  83.33 Feet

The information and depictions herein are for informational purposes and Waukesha County specifically disclaims accuracy in this reproduction and specifically admonishes and advises that if specific and precise accuracy is required, the same should be determined by procurement of certified maps, surveys, plats, Flood Insurance Studies, or other official means. Waukesha County will not be responsible for any damages which result from third party use of the information and depictions herein, or for use which ignores this warning.

### Notes:

Printed: 10/5/2017



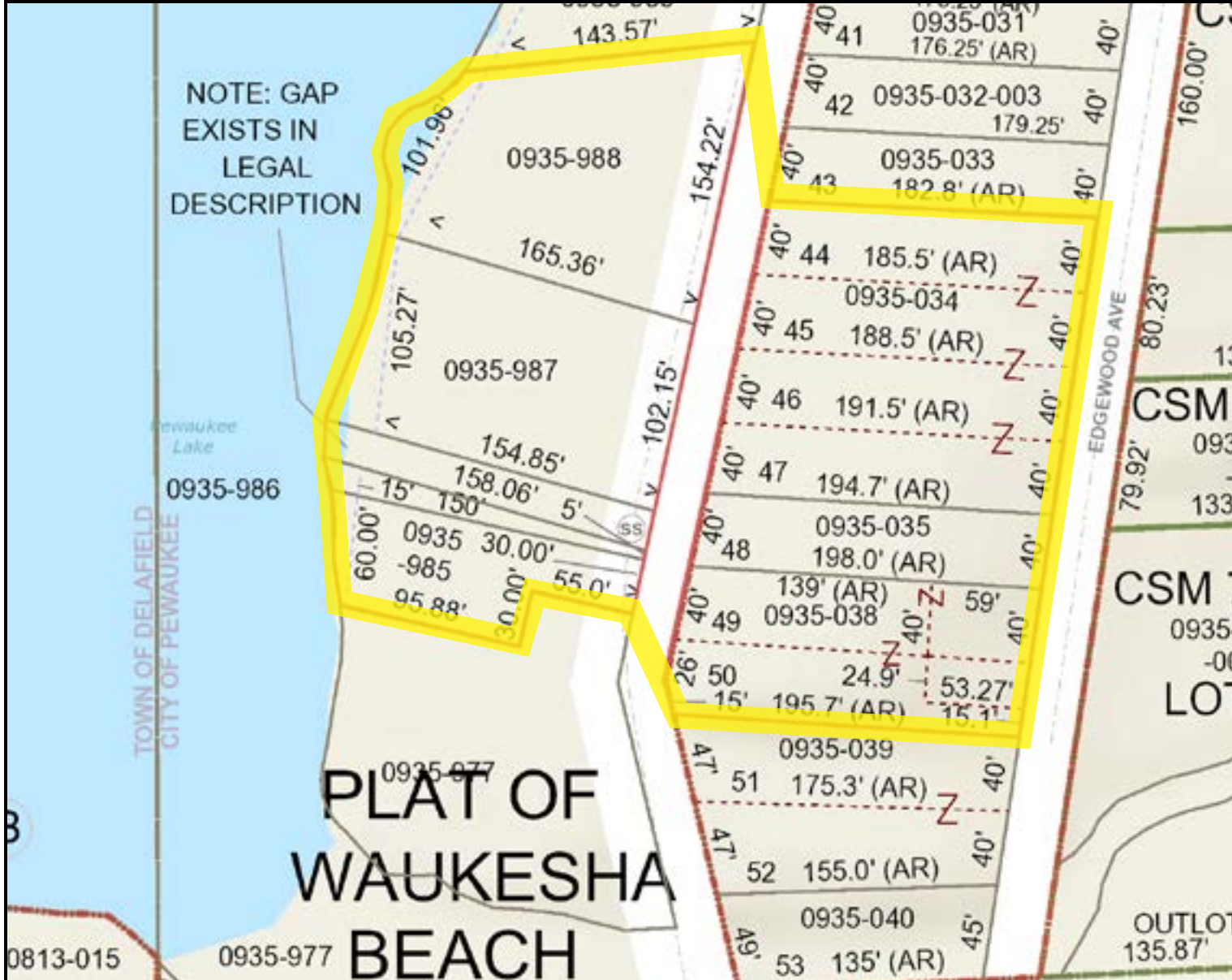

### Legend

- Retired Plats**
  - Assessor Plat
  - Condo Plat
  - CSM
  - Subdivision Plat
- Municipal Boundary\_1K
- Railroad\_1K
- SimultaneousConveyance**
  - Assessor Plat
  - CSM
  - Condo Plat
  - Subdivision Plat
- Cartoline\_1K**
  - <all other values>
  - EA-Easement\_Line
  - PL-DA
  - PL-Extended\_Tie\_line
  - PL-IA
  - PL-Meander\_Line
  - PL-Note
  - PL-Original\_Parcel\_Line
  - PL-PT
  - PL-Tie
  - PL-Tie\_Line
  - ROW\_CL
  - RR\_CL
  - RW\_Radius
  - SD-SD\_Block\_O\_100
  - SD-SD\_Block\_O\_200
- TaxParcel\_1K
- Road Centerlines\_4K
- publication.GISEDITOR.F
- Waterbodies\_36K
- Waterlines\_36K
- FlowCenterline

### CONTACT:

**Pete Slezak**  
414-272-6721  
pslezak@barrycre.com

**Kurt Van Dyke, CCIM, SIOR**  
414-272-6726  
kurt@barrycre.com

0 83.33 Feet

The information and depictions herein are for informational purposes and Waukesha County specifically disclaims accuracy in this reproduction and specifically admonishes and advises that if specific and precise accuracy is required, the same should be determined by procurement of certified maps, surveys, plats, Flood Insurance Studies, or other official means. Waukesha County will not be responsible for any damages which result from third party use of the information and depictions herein, or for use which ignores this warning.